

## ● Plastic Housing for Single Hold 1PPX



# PLASTIC HOUSING FOR SINGLE HOLD

## 1PPX Type

○ Using this product for filtering organic solvents may require antistatic measures.

### Features

- A plastic housing for a single cartridge filter, consisting of a head and body.
- Made from high-purity polypropylene with no fillers or colorants, it can be used to filter high-purity chemicals and ultrapure water among others with little elution from the housing.
- The smooth interior surface of the housing reduces the residence and adhesion of particulates and microorganisms, achieving excellent sanitary properties.
- 1PPX units are available for 250 mm and 500 mm type filters, supporting cartridge filters with shape codes F (flat gasket, DOE), M and H (222 O-ring, SOE); and TCC type and TCW type filters.



### Applications

- Filtration of ultrapure water, organic solvents, acid and alkaline solutions, beverages, food, plating solutions, oil, paint used in various industries

### Specifications

Product Name		1PPX-1		1PPX-2	
		-FS	-MS	-FS	-MS
Product Code		26980501	26980503	26980502	26980504
Cartridge Capacity		250 mm × 1		500 mm × 1	
Compatible Cartridge Filter Shape Code		F (flat gasket DOE) and TCC and TCW types	M and H (222 O-ring SOE)	F (flat gasket DOE) and TCC and TCW types	M and H (222 O-ring SOE)
Inlet and Outlet		Rc3/4 (R3/4 with nipple)			
Length	H (mm)	361		621	
	W	181mm			
Maximum Pressure		0.5MPa (60°C)			
Maximum Operating Temperature		60°C			
Material	Head	Polypropylene			
	Body	Polypropylene			
	O-ring	Silicone (standard)			
	Vent Plug	Polypropylene			
	Drain Plug	Polypropylene			
	Adapter	Polypropylene	–	Polypropylene	–
	Adapter Spring	SUS304 (standard)	–	SUS304 (standard)	–
R3/4 Nipple		Polypropylene			
Weight (kg)		0.9	0.8	1.2	1.1

- 1PPX type units cannot be used for gas filtration.
- 1PPX type units cannot be used for autoclave sterilization.
- Use thread-sealing tape on tapered inlet and outlet.
- Made with plastic, this product deteriorates over time.  
The extent of deterioration depends on the condition of use: the history of temperature, pressure, chemicals, and other factors. If you find any abnormalities, replace it with a new product or a part sold separately, if any.
- Do not connect a metal tube directly to the head.
- Do not tighten the vent plug or drain plug with a wrench or other tools.

### Product Name

1PPX-■-■-■-■■

Code	Cartridge Size (mm)	Code	Compatible Cartridge Filter Shape Code	Code	O-ring Material	Code	Pressure Gauge	Code	Adapter Spring Material
1	250	F	F (flat gasket DOE) and TCC and TCW types	S	Silicone (standard)	0	None (standard)	0	SUS304 (standard)
2	500	M	M and H (222 O-ring SOE)	V	FPM	1	IN side: 1 (wetted section: brass)	1	PE coating
				D	EPDM	2	IN and OUT sides: 1 each (wetted section: brass)	2	Titanium
				P	Perfluoro-Elastomer	3	IN side: 1 (wetted section: SUS316)		
						4	IN and OUT sides: 1 each (wetted part: SUS316)		

(for a product with the compatible cartridge filter shape code F)

\* The gauge is included in the package of units with a pressure gauge but is not mounted.

### Exploded View of 1PPX Type

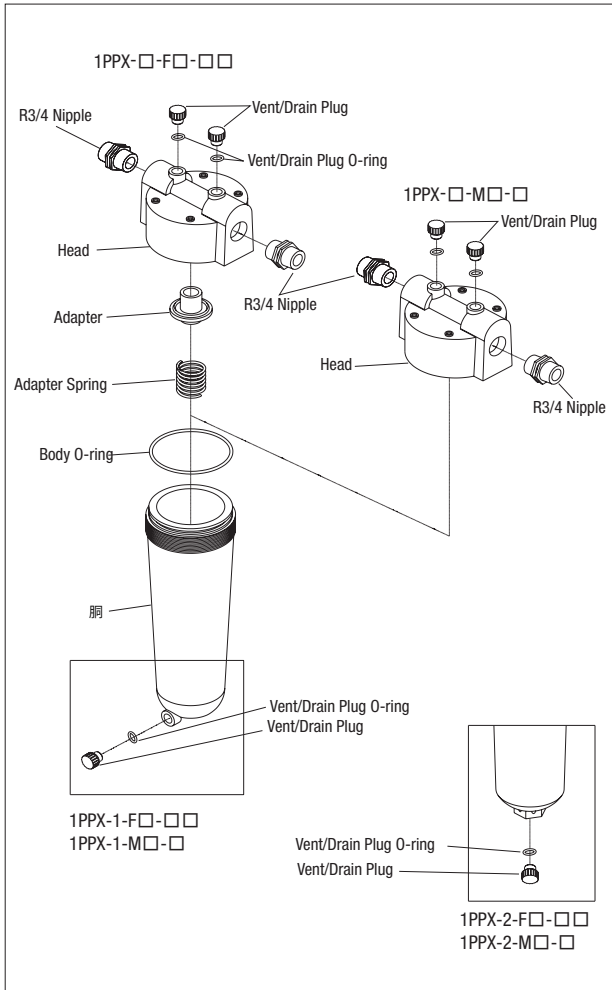

### Optional Housing Accessories

Product Name	Code	Specifications	Photo No.
O-ring (body and plug)	S	Silicone (standard)	-
	V	FPM	-
	D	EPDM	-
	P	Perfluoro-Elastomer	-
Pressure Gauge	0	None (standard)	-
	1	IN side: 1 (pressure gauge with vent valve, brass, 0.7 MPa)	1
	2	IN side: pressure gauge with vent valve; OUT side: pressure gauge only, 1 each (brass, 0.7 MPa)	2
	3	IN side: 1 (pressure gauge with vent valve, SUS316, 0.6 MPa)	-
Adapter Spring	4	IN side: pressure gauge with vent valve; OUT side: pressure gauge only, 1 each (SUS316, 0.6 MPa)	-
	0	SUS304, electropolishing finish (standard)	3
	1	PE-coated SUS304	4
	2	Titanium	5

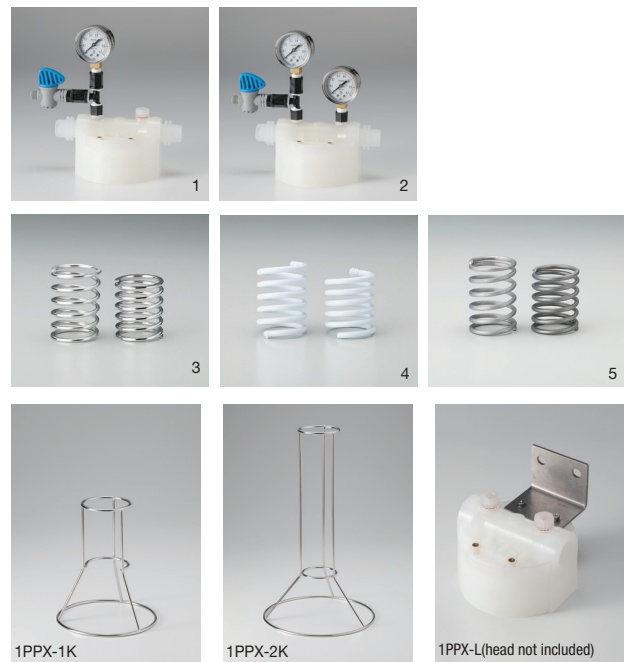

### Housing Accessories

Product Name	Stainless Steel Stand		Wall-mounted Bracket	Fastener	Hose Adapter (2 pcs.)
	1PPX-1K	1PPX-2K	1PPX-L		
Product Code	28980506	28980507	28980508	28980509	28980510
Compatible with	1PPX-1 (for 250 mm type)	1PPX-2 (for 500 mm type)	Common to 1PP-1 and 1PP-2		
Material	SUS304		SUS304	POM*	Polypropylene

\* POM: Polyacetal

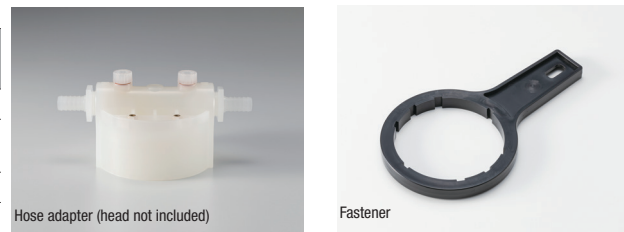

- Specifications listed in this brochure are subject to change without notice.
- ADVANTEC is a trademark / registered trademark that belongs to Toyo Roshi Kaisha, Ltd. And its group companies in Japan and other countries.

Toward the Future of Science  
**ADVANTEC**

**ADVANTEC TOYO KAISHA, LTD.**  
Overseas Trade Division  
Hibiya-Kokusai BLDG, 2-2-3, Uchisaiwaicho,  
Chiyoda-ku, Tokyo, 100-0011 Japan  
Phone +81-3-5521-2181  
Fax +81-3-5521-2182  
E-mail atk-otd@ADVANTEC.cp.jp  
URL <https://www.ADVANTEC.co.jp/en/>

**ADVANTEC** MFS, Inc.

**ADVANTEC MFS, INC.**  
6723 Sierra Court, Suite A  
Dublin, California 94568 U.S.A.  
Phone (800)334-7132  
+1-925-479-0625  
Fax +1-925-479-0630  
E-mail sales@advantecmfs.com  
URL <https://www.advantecmfs.com>